

3 X 3m Folding Gazebo Operating Instruction PLU-058459

Please read this instruction manual carefully and retain for future reference.

OPEN GENTLY

CLOSE GENTLY

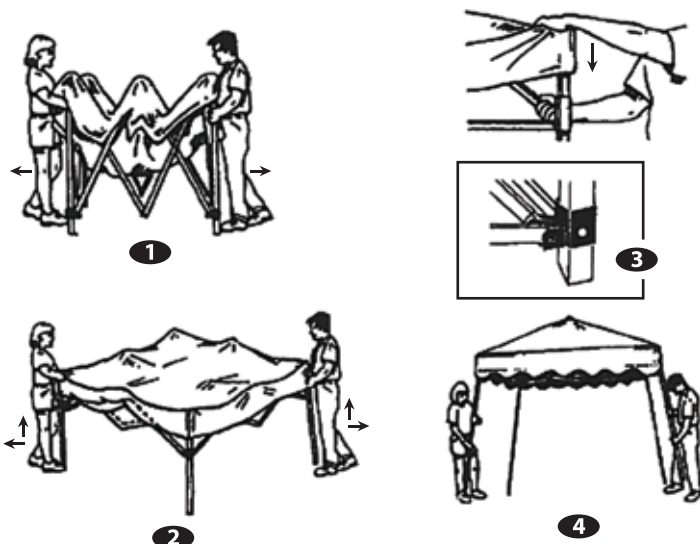

HOW TO SET UP

Follow these instructions carefully to avoid pinching your hands or fingers in any of the moving parts as the frame opens and closes. It requires two people to erect the fold up super cover.

1. Place your fold up super cover in the center of the area to be sheltered. Remove the carry bag and stand the fold up super cover on it's feet. With partner on the opposite side, grasp two outer legs, slightly lift the frame off the ground and take a step backwards, stopping at full (outstretched) arms length.
2. Each Partner should grasp the top and bottom of the diamond (see diagram) formed by the side supports on opposite sides and push hands together while stepping backwards until the shelter is fully opened. Be careful not to pinch your fingers or to pull backwards too hard as this will result in the side supports bending.
3. Engage the slider at each corner by pushing up with one hand while holding down the top of the leg with the other hand (see diagram). A snap button will engage in the locating hole. Repeat this operation on the remaining three legs.
4. You and your partner should each place a foot on the foot plate of the bottom of adjacent legs and lift up the leg, sliding the inner leg out until the snap button will engage in the locating hole. Repeat this operation for the other two legs.
5. Square up the fold up super cover. Attach the Velcro tabs, located on the underside of the top cover, around the frame struts.
6. Use the guy ropes attached to the ring at each corner of the roof cover and stakes, to secure your fold up super cover to the ground or just use the stakes through the hole in each legs foot.
7. Do not use in extreme weather conditions.
8. Never place hot / cooking appliances inside or near the tent.
9. Not suitable for use in severe or adverse weather conditions.
10. For use as a temporary shelter.
11. For outside and occasional use only.
12. Wipe clean only.
13. Keep away from children.

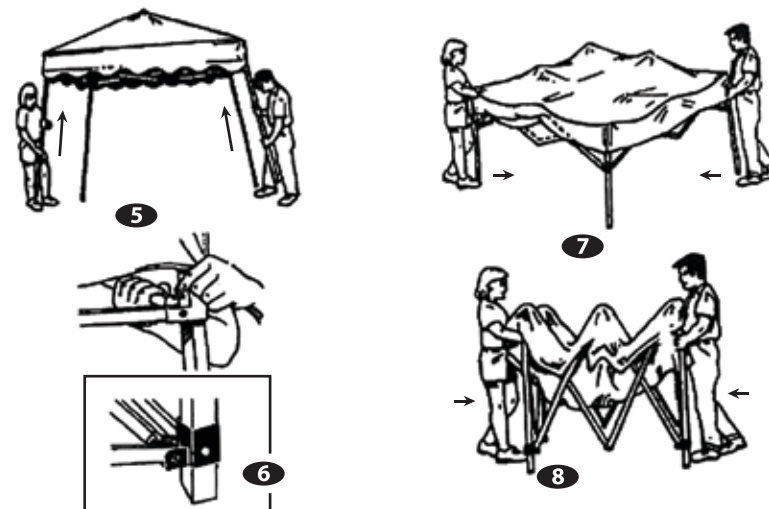

HOW TO TAKE DOWN

CAUTION:

Attempting to erect this super cover in windy conditions may be hazardous and could result in injury and or damage to the products.

1. Remove any leg stakes and guy ropes, undo the Velcro tabs of the top cover from around the frame.
2. You and your partner should each lift up two adjacent outer legs slightly, depress the snap button and push the telescopic inner legs into the outer legs. Repeat for the remaining two legs.
3. Release the slider at all four corners by a slight upward pressure with one hand while depressing the snap button to release the slider with the other. Push slider down past the snap button.
4. Each partner should grasp the top of the diamond (see diagram) on opposite sides and slightly lift up. Shake the canopy a little. Pull hands apart while stepping towards your partner until the unit is three quarters closed.
5. Grasp the two outer legs, slightly lift off the ground and push together to fully close.

BE CAREFUL NOT TO PINCH FINGERS.

DO NOT PUSH HARD.

Please ensure the canopy material is dry before returning into storage bag.

Warning:

Keep all flame fireand heat sources away from this Gazebo.

This tent is made with fabric that is flame resistant, but not fire proof.

The fabric will burn if left in continuous contact with any flame source.

Do not use in severe or adverse weather condition (especially high winds).

Keep away from fire and inflammable objects.

For use only as a temporary shelter.

For outside and occasional use only.

Never place hot/cooking appliances inside or near the product.

